

Assembly Instructions and Operations Handbook for Models 16 and 18

Congratulations!

You are the proud owner of an Equinox ATV Trailer. Your trailer is partially knocked-down for easy shipment, assembly is required. Follow the simple instructions inside. Save this brochure - DO NOT DISCARD.

**BROKEN OR MISSING PARTS?
QUESTIONS?**

DO NOT RETURN TO THE MERCHANT

TO OBTAIN PARTS THAT WILL BE SENT TO YOU FREE OF CHARGE,
PLEASE CALL OUR HELP LINE **1-800-665-7487** OR E-MAIL info@eqnx.biz

1 Year Limited Warranty

Required Tools

- M10 Wrench or Socket
- M17 Wrench
- M19 Socket
- Vice Grips
- #3 Phillips Screwdriver
- M13 Wrench
- M17 Socket
- Ratchet
- Drill
- Grease Gun
- M13 Socket
- M19 Wrench
- Pliers
- M8 Drill Bit



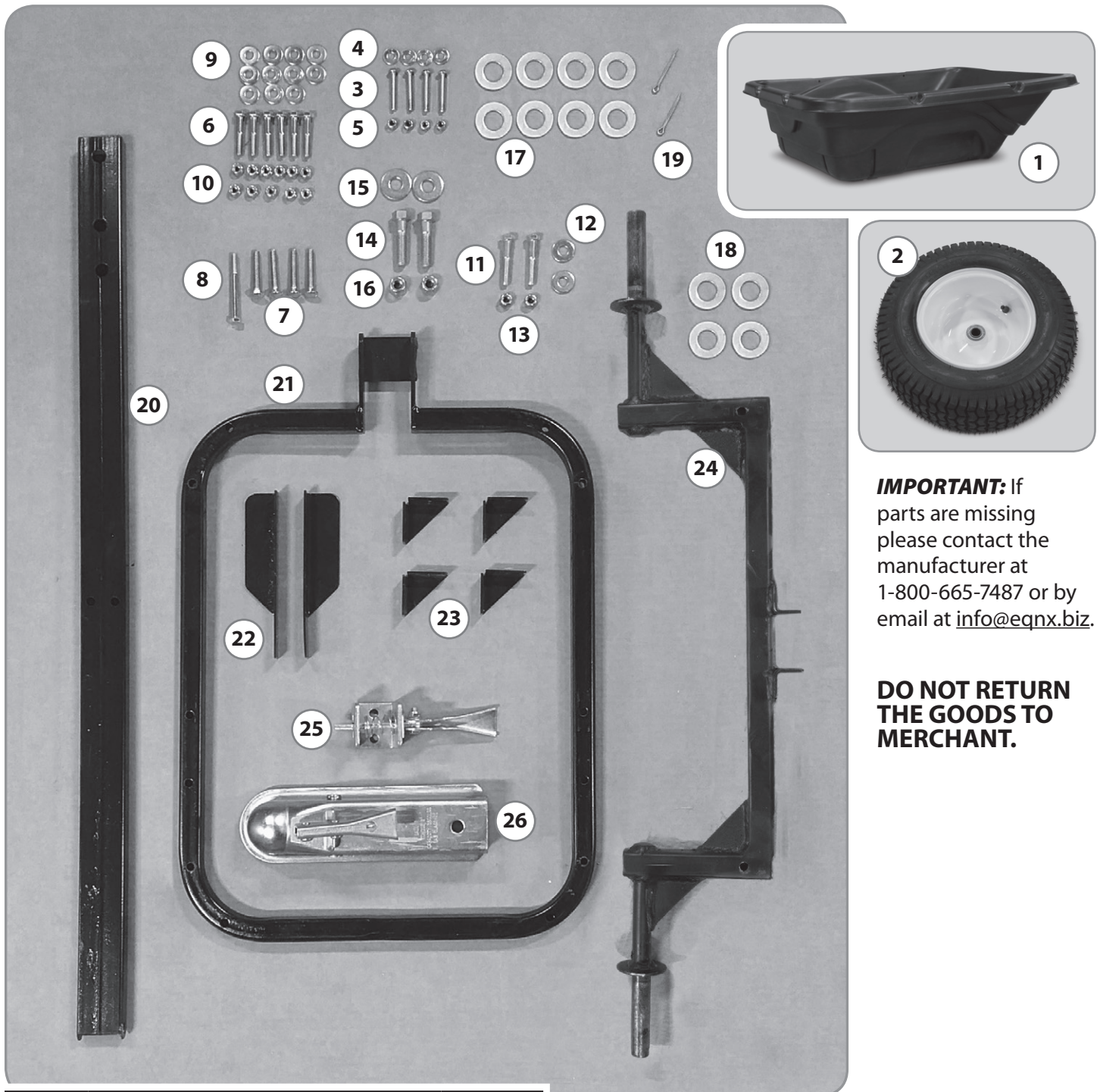

IMPORTANT: If parts are missing please contact the manufacturer at 1-800-665-7487 or by email at info@eqnx.biz.

DO NOT RETURN THE GOODS TO MERCHANT.

Part #	Description	Quantity
1	TRAILER BODY	1
2	Tire and Rim	2
3	M6 x 45mm Round Combination Bolt	4
4	M6 Washer	4
5	M6 Nylon Locknuts	4
6	M8 x 45mm Hex Head Bolts	6
7	M8 x 45mm Carriage Bolts	4
8	M8 x 80mm Hex Head Bolts	1
9	M8 Washers	11
10	M8 Nylon Locknuts	11
11	M10 x 50mm Hex Head Bolts	2
12	M10 Washers	2
13	M10 Nylon Locknuts	2

Part #	Description	Quantity
14	M12 x 50mm Hex Head Bolts	2
15	M12 Washers	2
16	M12 Nylon Locknuts	2
17	20mm Axle Washers	8
18	20mm Thin Axle Shims	4
19	4mm Cotter Pins	2
20	Hitch Bar	1
21	Frame	1
22	Front Body Supports	2
23	Frame Gussets	4
24	Axle Assembly	1
25	Tipper Latch	1
26	Ball Coupler	1

Stage 1: Frame Assembly

For this stage you will require:

Quantity	Description (Part #)	Quantity	Description (Part #)	Quantity	Description (Part #)
1	Frame (21)	4	Frame gussets (23)	2	Front body supports (22)
6	M8 x 45mm Hex head bolts (6)	6	M8 Washers (9)	6	M8 Nylon lock nuts (10)
4	M6 x 45mm Round Combination Bolt (3)	4	M6 Washers (4)	4	M6 Nylon lock nuts (5)
1	Axle Assembly (24)				

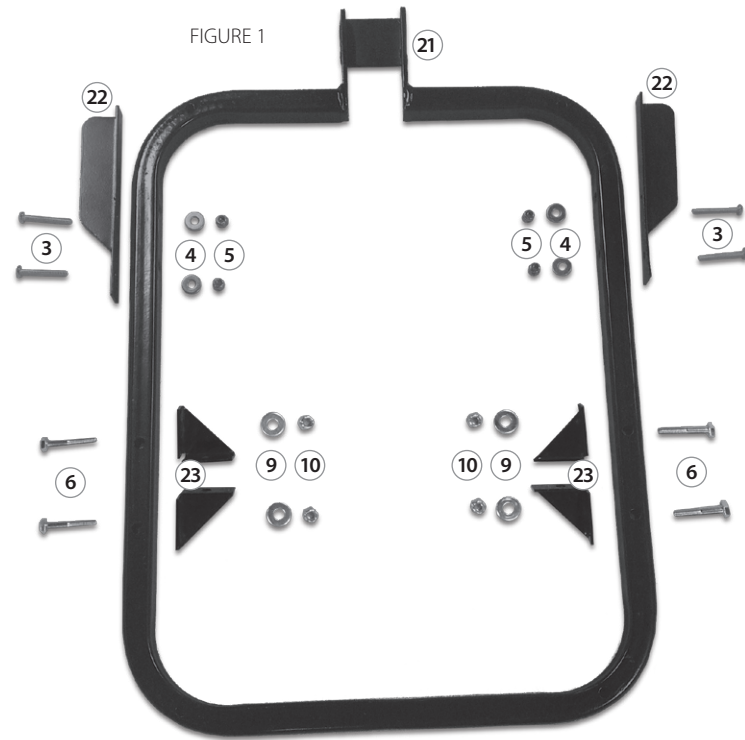

Lay out initial parts as shown in fig 1.

For your frame to be in the correct position, place the frame with the flat plate for the hitch channel on the bottom. Attach front body supports to each side of the frame using M6 x 45mm round combination bolts with washers and nylon locknuts (see fig. 2).

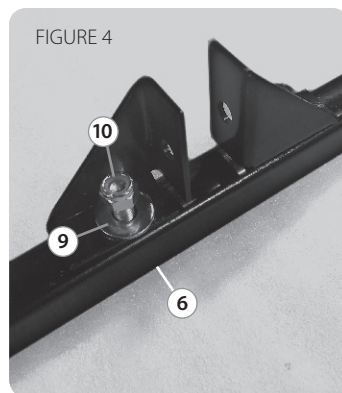
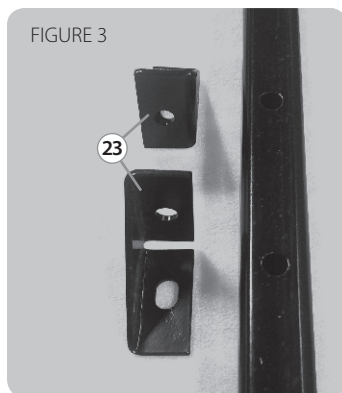
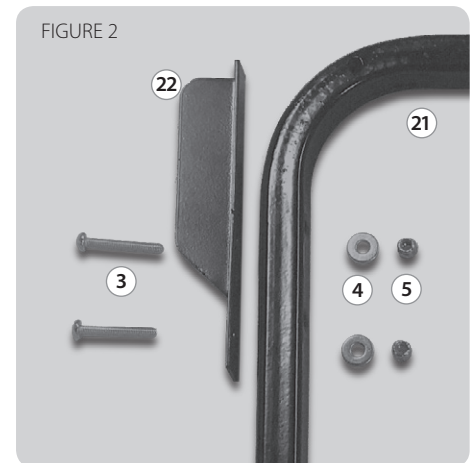

Using the slotted side of the gusset, attach the 4 gussets onto the frame using the M8 x 45mm hex head bolts with washers and nylon locknuts. Ensure the locknuts are mounted on the gusset side (see fig 3 and 4). Do not tighten.

Attach the axle assembly (see fig 5) to the frame gussets using M8 x 45mm hex head bolts with washers and nylon locknuts. Ensure the welded hitch bar mounts are in the correct position (see fig 6).

Tighten all hardware.

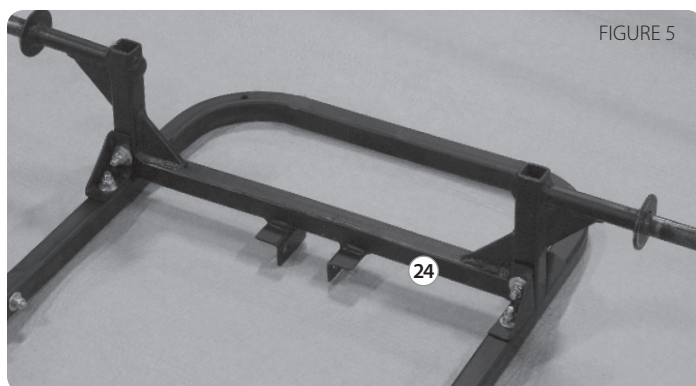

Stage 2: Hitch Assembly

For this stage you will require:

Quantity	Description (Part #)	Quantity	Description (Part #)	Quantity	Description (Part #)
1	Tipper Latch (25)	1	Ball Coupler (26)	1	Hitch Bar (20)
2	M12 x 50mm Hex Head Bolts (14)	2	M12 Washers (15)	2	M2 Nylon Locknuts (16)
2	M10 x 50mm Hex Head Bolts (11)	2	M10 Washers (12)	2	M10 Nylon Locknuts (13)
1	M8 x 80mm Hex Head Bolt (8)	1	M8 Washers (9)	1	M8 Nylon Locknuts (10)
1	Frame Assembly (from Stage 1)				

FIGURE 7

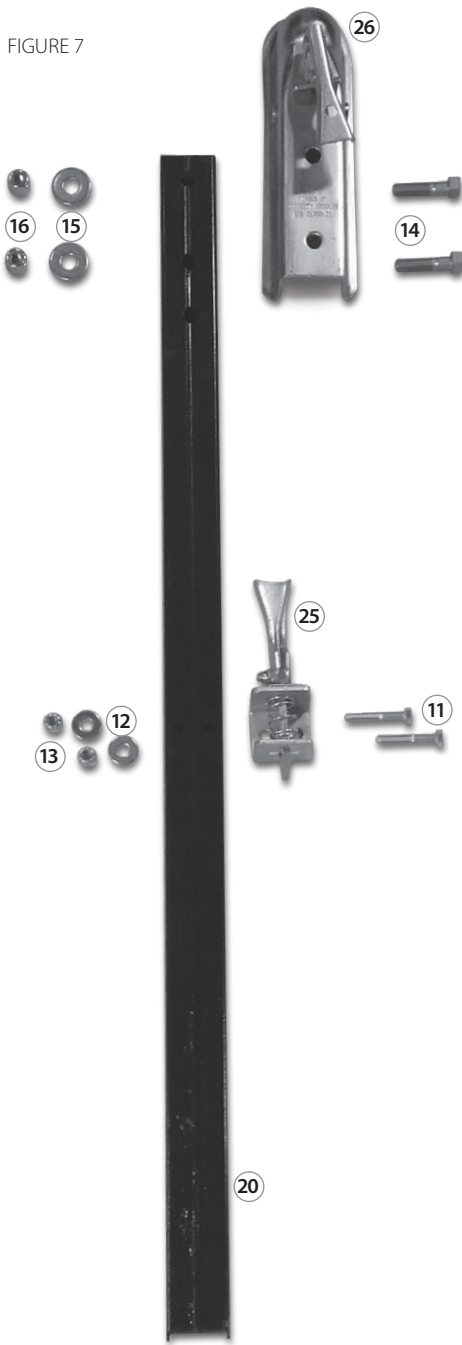

Lay out parts as shown in fig 7.

Attach the tipper latch using M10 x 50mm hex head bolts with washers and nylon locknuts. Ensure tipper latch is in the release position before installing bolts (see fig 8).

Attach ball coupler using M12 x 50mm hex head bolts with washers and nylon locknuts (see fig 8).

FIGURE 8



Attach hitch to the welded hitch bar mounts on the axle assembly using the M8 x 80mm hex head bolt with washer and nylon locknut (see fig 9). Ensure the tipper latch is facing down.

FIGURE 9



Stage 3: Attaching the Body

For this stage you will require:

Quantity	Description (Part #)	Quantity	Description (Part #)	Quantity	Description (Part #)
4	M8 x 45mm Carriage Bolts (7)	4	M8 Washers (9)	4	M8 Nylon Locknuts (10)
1	Trailer Body Tub (1)	1	Frame Assembly (from Stage 2)		

FIGURE 10

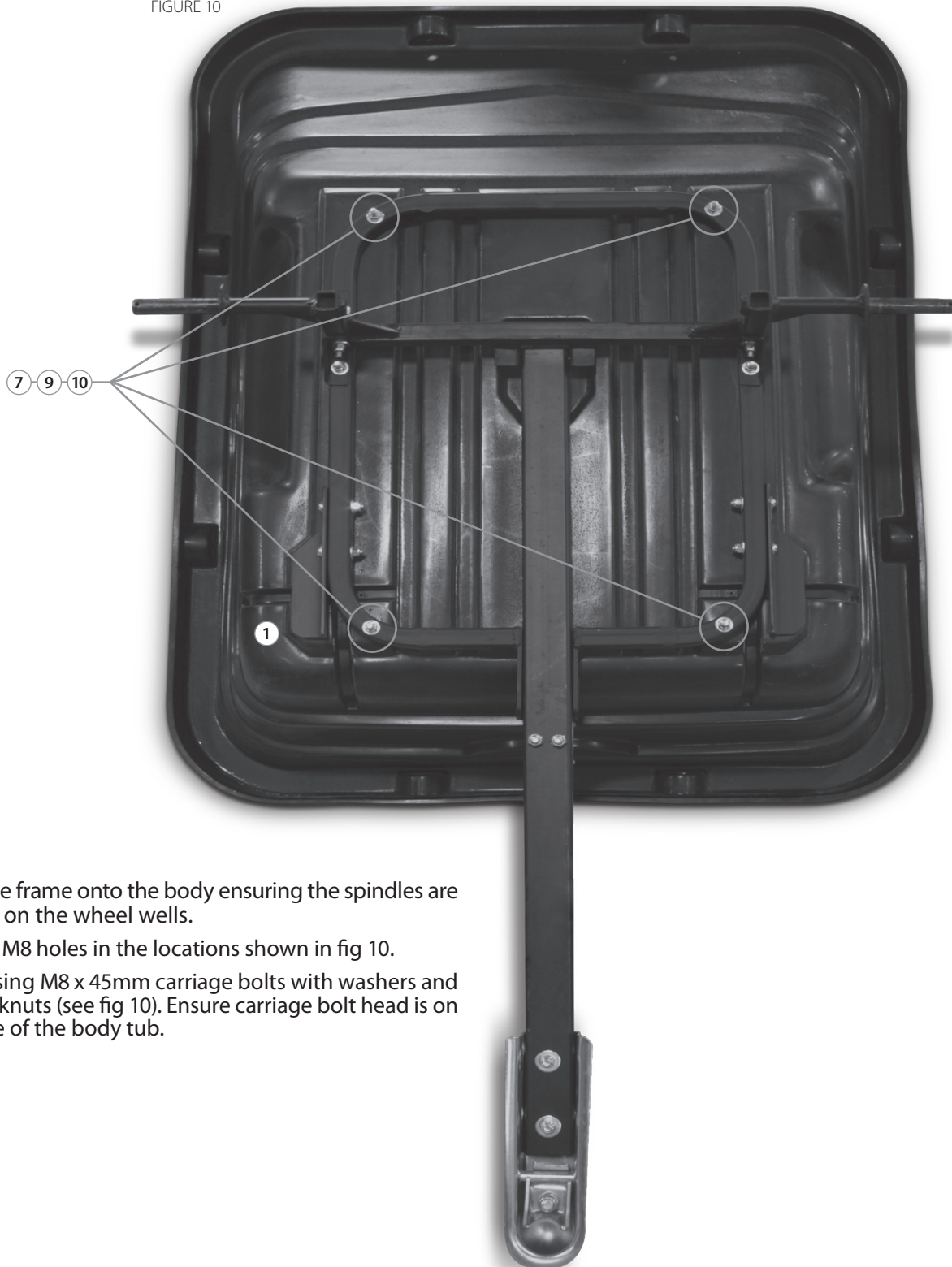

Center the frame onto the body ensuring the spindles are centered on the wheel wells.

Drill four M8 holes in the locations shown in fig 10.

Attach using M8 x 45mm carriage bolts with washers and nylon locknuts (see fig 10). Ensure carriage bolt head is on the inside of the body tub.

Stage 4: Attaching Wheels

For this stage you will require:

Quantity	Description (Part #)	Quantity	Description (Part #)	Quantity	Description (Part #)
1	Frame and Body Assembly (from Stage 3)	2	Tire and Rim (2)	2	Cotter Pins (19)
		8	Axle Washers (17) (4 required per 16" Wheel, 1 required per 18" Wheel)	4	20 mm Axle Shims (18) (Optional)

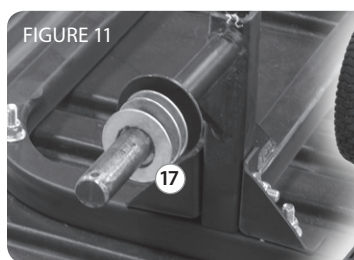

Add 3 axle washers to each spindle before installing wheels (see fig 11).

Then place a wheel on each spindle with the grease nipple facing outwards (see fig 12).

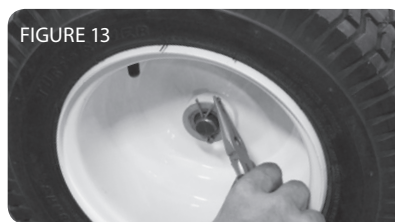
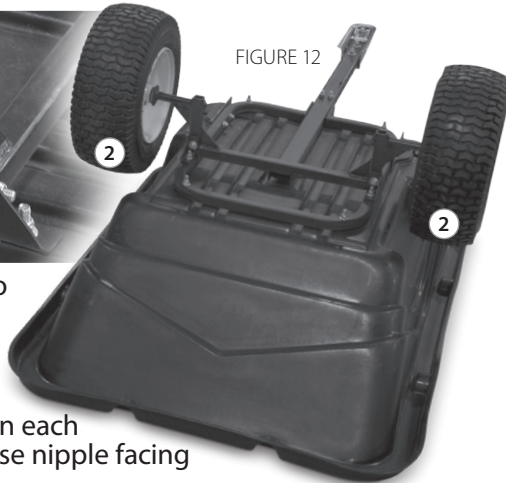

Add a single axle washer to the spindle on the outside of each wheel, and install cotter pins (see fig 13).

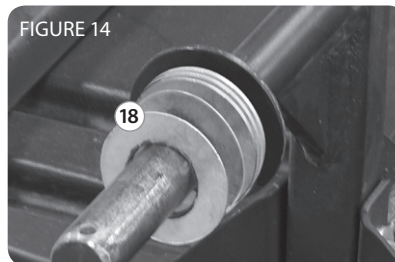

OPTIONAL: If there is a gap, remove the wheel and install shims along with the washers (see fig 14), then replace wheel and proceed.

Ensure both tabs of the cotter pins are separated after placement (see fig 15).

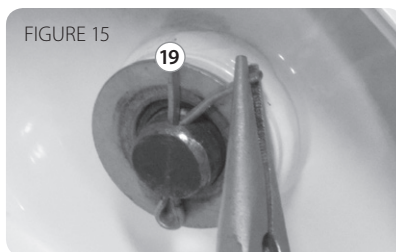

Finally, grease wheel bearings with a grease gun.

Warranty Information

Equinox recreational division is committed to producing high quality components and stands behind all our products. Equinox guarantees that all products will leave our building free from manufacturer's defects for the time period listed on our product warranty.

What does this Warranty not cover?

Any defect caused by abuse, misuse, neglect, carelessness, modification, improper maintenance, accident or the use of unauthorized parts or attachments.

What will we do to correct any problems?

We will repair or replace the defective product at the company's option.

What is the coverage period?

One year against manufacturing defects.

How can you get warranty service?

Contact our Customer Service representatives to report a warranty concern 1.800.665.7487 or email us at info@eqnx.biz.

What must you do to keep the Warranty in effect?

Keep a copy of your original proof of purchase.

All returns must be properly packaged and returned with the original proof of purchase.

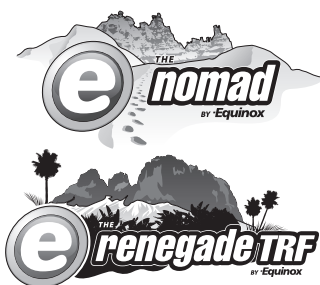

Toll Free (U.S.A.): 1-800-563-3352
Toll Free (Canada): 1-800-665-7487
Fax: (204) 694-7133
E-mail: info@eqnx.biz