



## DELIVERING YOU WITH PROFESSIONAL QUALITY RESULTS

The Maven 125IS is the ultimate home ironing station, delivering you with professional quality results. This home ironing station is equipped with multiple features that guarantee to save you time and effort during the ironing process including a 1L tank, a pro detail tip and 6 bar pump pressure. The Maven 125IS is made from high quality material, ensuring maximum durability and a long lifespan.

## FROM WHERE YOU LIVE TO WHAT YOU WEAR, WE'RE RIGHT THERE WITH YOU

At Reliable, we do what we love, and we take pride in doing it right. Quality, functionality, design and customer service play an equally important part in delivering what's right for you. From irons to steam cleaners to sewing machines, you can count on us to be right there with you. That's the Reliable Way.



**For more information on your product, to view instructional videos or to download the full user manual, visit [reliablecorporation.com](https://reliablecorporation.com)**



### Having trouble? Call us.

For service and/or technical assistance on this product, call our toll free number or email our support staff

**1-800-268-1649**  
[support@reliablecorporation.com](mailto:support@reliablecorporation.com)

# MAVEN 125IS

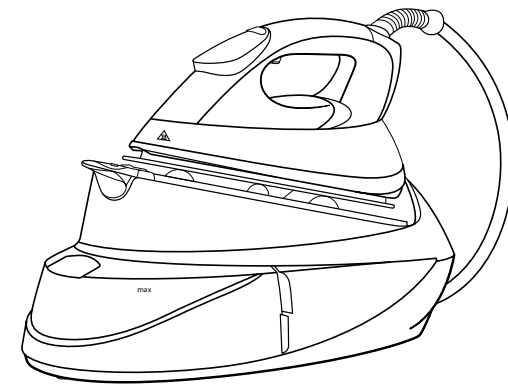

## QUICK START GUIDE



## Your New Unit

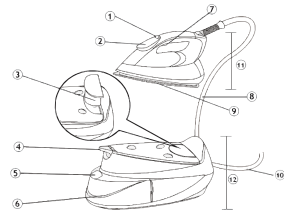

1	Function Button	2	Control Panel
3	Anti-Scale Cartridge	4	Carry Lock
5	Water Inlet Cover	6	Water Tank
7	Steam Trigger	8	Steam Hose
9	Soleplate	10	Power Cord
11	Iron Unit	12	Base

## Control Panel

Control Panel	Symbols	Description
		Auto Mode
		Temperature Settings
		Steam Level Indicator
		No Steam Indicator
		Anti-Scale Cartridge Indicator
		Auto Shut Off Indicator
		Eco Mode
		Self Clean Mode

## Using Your Maven 125IS

- Soak anti-scale cartridge in water prior to initial use of the iron in order to enhance the unit's performance. Push down on anti-scale cartridge to pop out of place. Immerse in water for 5 minutes. Pop cartridge firmly back into place.



- Remove the water tank from the base of the unit.
- Fill the tank with water to max level.



**\*Note** to preserve the life of your unit, we recommend using distilled water

- Put the water tank securely back into place to avoid any leaks.



- Plug your system into a suitable outlet.

**\*Note** do not use an extension cord when plugging in your iron system



- Press the function button on your unit and select your desired temperature. Once the desired temperature is set and the display icons on the control panel are no longer flashing, your unit is ready for use.

- Press the steam trigger and move your iron back and forth over the fabric. Do not hold your iron in one place for too long so that your fabric does not burn.

- For vertical steaming, hold your iron in an upright position 15-30 cm away from the fabric. Press steam trigger and run the iron up and down over the fabric, careful not to stay in one place for too long.

- During first time use, it may take 10-30 seconds for steam to start. This may take longer if cartridge is not completely soaked.



\*See Troubleshooting

- When you are finished ironing, unplug your Maven 125IS and allow for it to cool. Drain water tank after use.



The default function for your Maven 125IS is eco-mode. This mode will allow you to iron all fabrics without adjusting the temperature. If you want to switch to another mode, press the function key. See below for ironing recommendations:



TEMPERATURE SETTING	STEAM SETTING	FABRIC TYPE
.	Without Steam	Acetate, Elastane, Polyamide, Synthetic
..	With Steam	Polyester, Silk, Viscose, Wool
...	With Steam	Cotton
MAX	With Steam	Linen, Jean

## Troubleshooting

### My Maven 125IS is not producing steam when I press the trigger

If your Maven 125IS is not producing any steam, or producing very little, first check that your unit is on and that enough time has passed for the unit to have had a chance to heat up. Another possible cause is that the water tank is empty. Check your water tank level to see if the unit requires more water. Always ensure to unplug your unit prior to filling it with water.

### My Maven 125IS does not work

Perhaps the plug has accidentally come out of the socket or the socket does not work. Check if your Maven is properly plugged in to a functioning electrical outlet. Another potential cause could be that the anti-scale cartridge is not installed properly. Check to see that the cartridge is not loose, and has been securely inputted back into the unit. If your unit is plugged in, and the cartridge is properly in place, check to see that you have enough water in your tank.

### My Maven 125IS is making a loud noise

Your unit may make "chugging" noises upon initial use. This is normal - it is simply the water drawing into the unit. This "chugging" will sound for 20-40 seconds when first using your Maven 125IS. Hold down the steam button to assist with the water drawing process. If your unit requires more water, refill your water tank.

### The soleplate of my iron does not heat well

If you do not think that your iron's soleplate is heating well enough, perhaps the incorrect fabric/temperature setting has been selected. Press the function button in order to select a higher temperature setting.