



Hushtone by Cyclone

ENERGY STAR BATH FAN WITH BLUETOOTH SPEAKER

Bath Fan Installation- Tools & Materials Required

- * Electrical Drill
- * 1/2" Drill Bit for Drilling Pilot Holes into joist
- * 1-1/4" Drill Bit for Drilling Electrical Wiring Access Hole Through Joists (If Applicable)
- * #2 Phillips Screwdriver or Driver Bit
- * Wire Stripper & Cutter
- * Aluminum Foil Tape & or Duct Tape
- * Electrical Supplies for Wiring i.e Marrettes (wrenuts), Electrical Tape & Cable Connectors

Bath Fan Parts Supplied

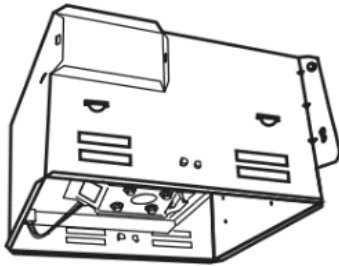

1x Fan

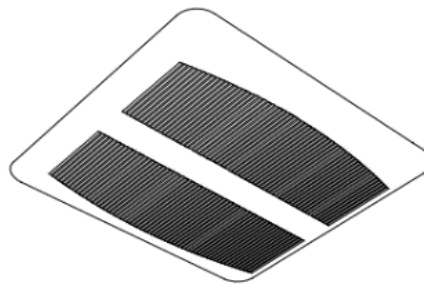

1x Plain Grille
(Includes 2x Grille Springs)

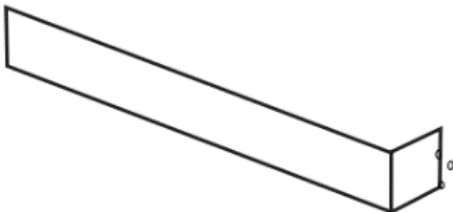

4x Mounting Brackets

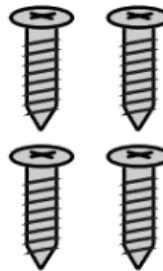

4x Flange Screws

Bath Fan Pre- Installed Electrical Wiring

Installation work and electrical wiring must be done by qualified person(s) in accordance with all applicable codes and standards, including fire-rated construction codes and standards

1x Black
1x White
1x Green



Bluetooth Speaker Pre-Installed Electrical Wiring

1x Brown
1x White
1x Black



CYCLONE BATH FAN SUGGESTED SWITCH REQUIREMENTS

For ideal set up, 1 switch is required

Switch- Fan Function

Bluetooth Speaker wired to a constant & independent power source for automatic syncing

For more information, contact the manufacturer

Cyclone Range Hoods Inc.
www.CycloneRangeHoods.com
Info@CycloneRangeHoods.com
1-888-293-5662