



# Acclaim Lighting

1500 Cherokee Parkway, Suite 100, Acworth, GA 30102

TEL: (866)845-5451 • FAX: (866)816-6165

Email: service@acclaim-lighting.com • www.acclaim-lighting.com

## Wall Mount Exterior Fixture Installation and Wiring Instructions



**WARNING:** To avoid electrical shock. Do not attempt to install the fixture in wet or rainy conditions. Always turn off electrical power at the circuit breaker or by disconnecting the fuse. Only use bulbs in compliance with manufactures specifications.  
**DO NOT ATTEMPT TO EXCEED MAXIMUM WATTAGE RATING.**

### TOOLS AND MATERIALS REQUIRED

Blade and or Phillips Head screw driver  
Step Ladder (if needed)  
Wiring supplires as required by electrical code:  
Wire connectors  
Electrical tape

### UNPACK THE FIXTURE

Check the contents of the box. You should receive:  
Outdoor fixture  
Mounting Hardware package.

## CAUTION

**WARNING:** Risk of fire.

Before installing your lighting fixture, thoroughly review the section titled WIRING CONNECTIONS.

If you do not have sufficient electrical wiring experience, please refer to a do-it-yourself wiring handbook or have your fixture installed by a qualified licensed electrician.

All electrical connections must be in accordance with local and National Electrical Code (NEC) standards.

If you are unfamiliar with proper electrical wiring connections obtain the services of a qualified electrician.

## GENERAL

Remove the fixture and the mounting hardware package from the box and make sure that no parts are missing by referencing the illustrations on the installation instructions.

To ensure success of the installation, read these instructions and review the diagrams thoroughly.

Save these instruction for future reference.

This fixture is intended to be mounted to a 4" x 4" x 2-1/8" deep metal outlet box.

The building structure must directly support the outlet box.

Before starting the installation, disconnect the power by turning off the circuit breaker or by removing the fuse at the fuse box. Turning the power off using the light switch is not sufficient to prevent electrical shock.

## WIRING CONNECTIONS

Required supply circuit: 120V, 60Hz.

Connect the white wire from the fixture to the white wire of the supply circuit.

Connect the black wire from the fixture to the black wire of the supply circuit.

Connect the green (or bare copper) colored wire to the grounding conductor of the supply circuit.

Use U.L./CSA listed wire connectors suitable for the size, type, and number of conductors.

No loose strands or loose connections should be present. Secure wire connectors with U.L./CSA listed electrical tape.

# WIRING INSTRUCTIONS

**WARNING: DISCONNECT POWER AT THE MAIN ELECTRICAL PANEL BEFORE INSTALLATION.**

If you are replacing an existing fixture. Remove and disconnect the old fixture.

1. Expose the Supply Wires from the Outlet Box.
2. Position Supply Wires with the White Supply Wire on one side of the Outlet Box, and the Black Supply Wire on the other side.
3. Thread Fixture Mounting Screws through Mounting Bracket as shown in illustration.
4. Attach Mounting Bracket to Outlet Box by allowing the Outlet Box Screws (provided with Outlet Box) to pass through the larger slots in the Mounting Bracket.
5. Connect Outlet Box Ground Wire to Mounting Bracket with Green hex-head Ground Screw by screwing into tapped hole in Mounting Bracket marked "GND" until tight (see detail).
6. Connect the Fixture Ground Wire to the Outlet Box Ground Wire using Wire Connector (not provided).
7. Connect the White Wire from the Fixture Assembly to the White Supply Wire from the outlet box using Wire Connector (not supplied).
8. Connect the Black Wire from the fixture Assembly to the Black Supply Wire from the outlet box using Wire Connector (not supplied).

**NOTE:** Strip 1-1/2" insulation from the Outlet Box Ground Wire (if insulated). Allow the stripped end to extend an extra 1" from the Ground Screw to enable connection to Fixture Ground Wire using wire connector (not provided). Reference chart for correct connection procedures, and wire accordingly.

Details 1, 2, 3 show the proper procedure to secure wires with Wire Connectors (not supplied).

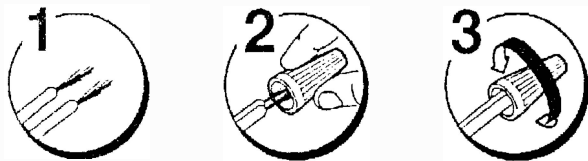
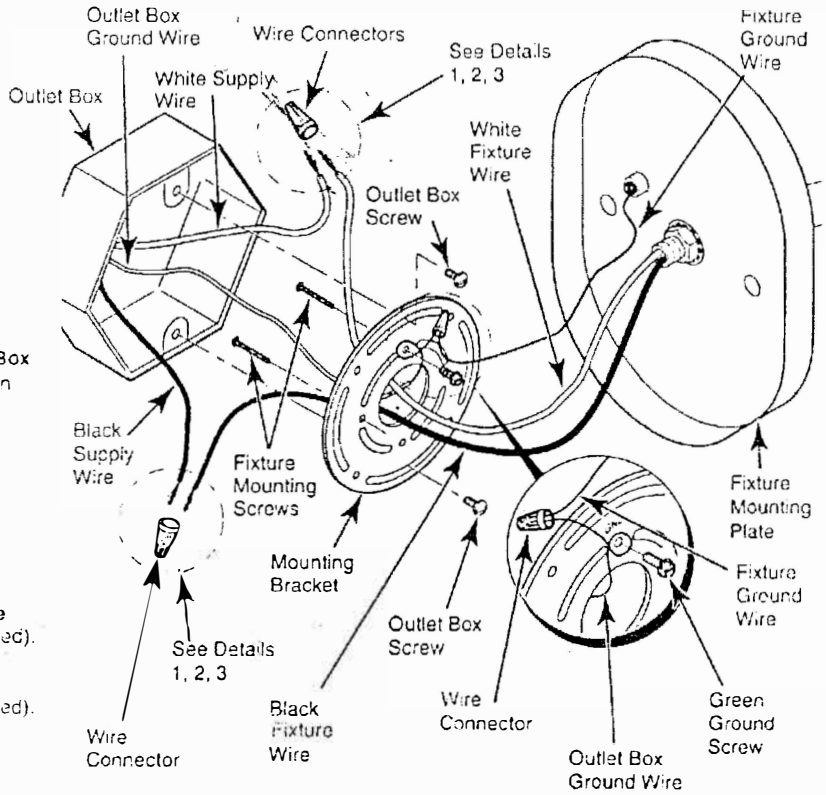

Connect Black or Red House Wire to:	Connect White House Wire to:	White, Marked, or Ribbed Fixture Wire
Black	White	 White Supply Wire
Parallel cord-SPT I & II (round & smooth)	Parallel cord-SPT I & II (square & ridged)	 Black, Unmarked, or Smooth Fixture Wire
Clear, Brown, Gold or Black (without tracer)	Clear, Brown, Gold or Black (with tracer)	 Black or Red Supply Wire
Insulated Wire (Other than GREEN) with copper conductor	Insulated Wire (Other than GREEN) with silver conductor	

# FIXTURE MOUNTING INSTRUCTIONS

1. After all connections are secure. Carefully tuck wires into the electrical Outlet Box. No loose strands or loose connections should be present.
2. Attach Fixture Mounting Plate to the Fixture Mounting Screws on the Mounting Bracket. Make sure no wires are pinched or exposed. Tighten Cap Screws or Ball Nuts to hold the Fixture securely in place.
3. To prevent moisture from entering the Outlet Box and the fixture's Mounting plate causing a short, apply a bead of clear caulking to outline the outside of the Fixture's Mounting Plate where it meets the wall. Leave a small space at the bottom to allow any condensation or moisture to escape.
4. Installation is now complete. Restore electricity and check the operation of your lighting Fixture.

