

- 1 Before installation of the StealthFlow, or any downspout extension, make sure the grade around the foundation slopes away from the house. There should be a 6 inch fall in the first 10 feet from the house.

Make sure the extension is sloping away from the foundation

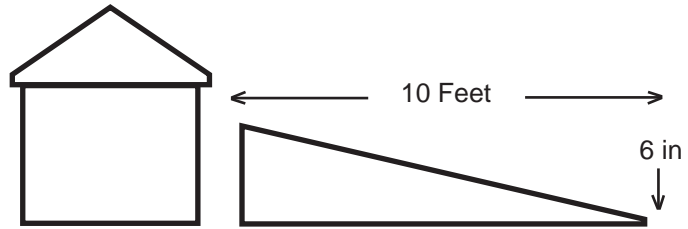

- 2 Snap together



- 3 Connection for a 2" x 2" and 2" x 3"



- 4 Installation over elbow

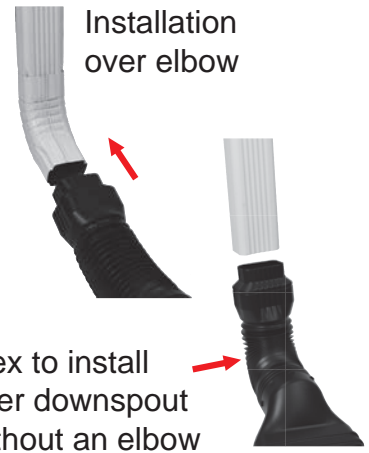

The purpose of downspout extensions is to move the high volume of rainwater from the roof and direct it away from the foundation. Any water that may seep from the connections will be less than the amount of water actually saturating the surrounding ground from the rainfall.

If a watertight seal is preferred, follow one of these following options:

Option #1



Accessories

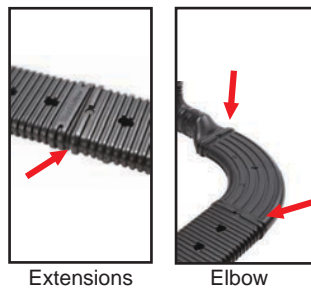

Option #2



- Using corrugated pipe tape / PVC black tile tape, simply tape around the seams.

- Starting on the side, run a bead of silicone caulk inside the flared female end of the StealthFlow connections.